

Electromagnetic gas valves КЭГ-9720



Designed for use in remote control system of gas burner units of steam and water boilers, heat-generators, domestic heating installations and in process pipeline systems for gas flow control as a shut-off valves.

Application

Placement in gas-fired boiler houses; in residential sector of municipal engineering equipped with gas stoves, gas water heaters, gas heating boilers.



Normally closed valves.

Basic technical characteristics

Characteristics	Values	Remarks
Port area Ду, mm	20; 25; 32; 40; 50; 65; 80	
Opening/closing time, s	1	
Pressure range, MPa	0-0,4 0-0,1	Ду=20; 25; 65; 80 mm Ду=32; 40; 50; 65; 80 mm
Switching frequency, 1/hour	1000 300	Ду=20; 25; 32; 40; 50 mm Ду=65; 80 mm
Switching life	1x10 ⁶ 5x10 ⁶	Ду=20; 25; 32; 40; 50 mm Ду=65; 80 mm
Volume flow rate, m ³ /h (on air): for Ду=20 mm for Ду=25 mm for Ду=32 mm for Ду=40 mm for Ду=50 mm for Ду=65 mm for Ду=80 mm	3,6 4,9 160 180 200 250 440	at P _{Bx} = 0,4 MPa at differential P=0,01MPa at differential P=0,01MPa at P _{Bx} = 0,1 MPa at differential 0,0076 MPa
Supply voltage, V	220	50 Hz
Consumed power, VA	35 75 90	Ду=20; 25; 32; 40; 50 mm Ду=65 mm Ду=80 mm
Protection degree	IP 65 IP 40	Ду=65; 80 mm Ду=20; 25; 32; 40; 50 mm
Ambient temperature, °C	-30/+40	
Overall dimensions, mm, not more: LxWxH		weight, kg, not more
Ду=20mm	90x165x110	2,5
Ду=25mm		2,8
Ду=32mm	100x190x160	3,7
Ду=40mm		3,9
Ду=50mm		4,2
Ду=65mm	155x290x320	13
Ду=80mm		15

Electromagnetic gas valves КЭГ-9720



Thread according to ГОСТ 6357-73 or flanges according to ГОСТ 12815-80 are for connection to gas pipeline.
 Valve components are made of corrosion-resistance materials (aluminium, stainless steel).
 Valve seat is protected from contaminations with filter at input.
 Valve is equipped with system of electrical connection with integrated rectifier and ground contact.
 There is a nipple with thread 1/4" in valve enclosure for connection of pressure sensors, test devices, pipeline of pilot burner and other elements. Gate sealability is according to rates A ГОСТ 9544-93.

Versions of valves КЭГ-9720

Designation	Ду	Version	Remarks	Manner of fastening
ИБЯЛ.685181.001-09, -10	20, 25	NC	Pwork.=0,4 MPa	coupling fig.1
ИБЯЛ.685181.001-05, -03, -04	32, 40, 50	NC	Pwork.=0,1 MPa	coupling fig.1
ИБЯЛ.685181.001-11, -13	65, 80	NC	Pwork.=0,4 MPa	flange fig.2
ИБЯЛ.685181.001-12, -14	65, 80	NC	Pwork.=0,4 MPa	flange fig.2

Fig. 1

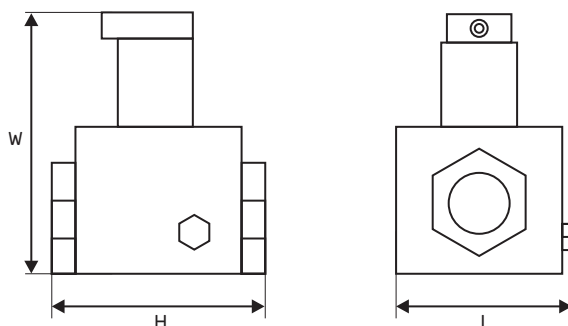
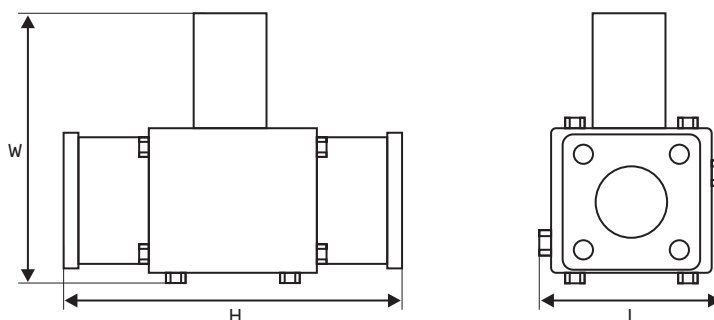

Fig. 2



Operating position - electromagnet up.
 Thread according to ГОСТ 6357-73 or flanges according to ГОСТ 12815-80 are for connection to gas pipeline.



Note
 Electromagnetic valves are supplied as individual items and as a part of safety systems (gas alarms СГГ6М, СОУ-1, СТГ-1).